



An Roinn Iompair
Department of Transport



N25 Rosslare Europort Access Road

WEXFORD COUNTY COUNCIL
COMPULSORY PURCHASE ORDER
No. 9 of 2022

M
M
MOTT
MACDONALD

Document reference: 229100548-MMD-0000-RE-RP-C-0038 P3





N25 Rosslare Europort Access Road
Wexford County Council Compulsory Purchase Order No. 9 of 2022

**Schedule of Land Proposed to be Compulsorily Acquired
And
Public Right of Way Proposed to be Extinguished**

Index:

Drawings:

- 229100548-MMD-0000-RE-DR-C-0020 Compulsory Purchase Order No. 9 of 2022 Deposited Map Sheet 1 of 2**
- 229100548-MMD-0000-RE-DR-C-0021 Compulsory Purchase Order No. 9 of 2022 Deposited Map Sheet 2 of 2**
- 229100548-MMD-0000-RE-DR-C-0022 Landowner Map Wexford County Council**
- 229100548-MMD-0000-RE-DR-C-0023 Landowner Map Wexford County Council**
- 229100548-MMD-0000-RE-DR-C-0024 Landowner Map Breda Kelly**
- 229100548-MMD-0000-RE-DR-C-0025 Landowner Map Irish Water**
- 229100548-MMD-0000-RE-DR-C-0026 Landowner Map Breda & Pat Heffernan**
- 229100548-MMD-0000-RE-DR-C-0027 Landowner Map National Vehicle Distribution LTD**
- 229100548-MMD-0000-RE-DR-C-0028 Landowner Map Anne Gleeson**
- 229100548-MMD-0000-RE-DR-C-0029 Landowner Map John Paul Kelly**
- 229100548-MMD-0000-RE-DR-C-0030 Landowner Map Coras Iompair Eireann (C.I.E)**
- 229100548-MMD-0000-RE-DR-C-0031 Landowner Map David Michael Laheen**

Schedule – Part I - Land Proposed to be Compulsorily Acquired

Schedule – Part II - Description of Public Right of Way Proposed to be Extinguished

Drawings

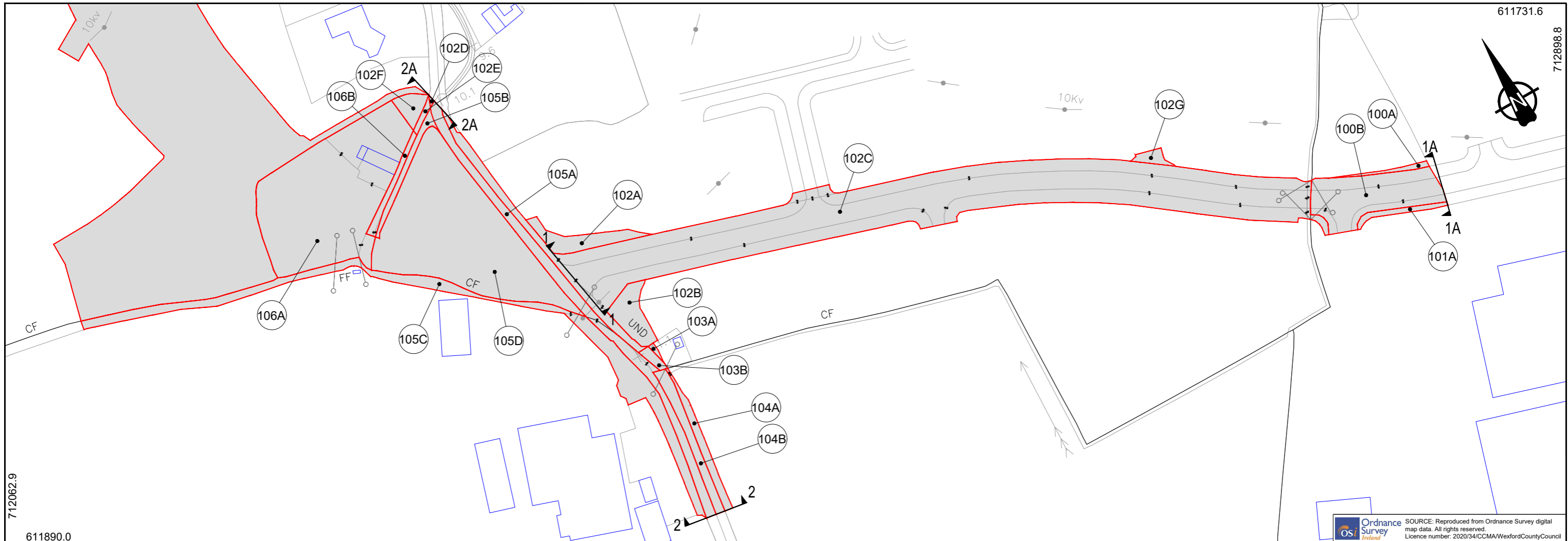

OS Ordnance Survey Ireland SOURCE: Reproduced from Ordnance Survey digital map data. All rights reserved. Licence number: 2020/34/CCMA/WexfordCountyCouncil

Plan Scale - 1:1,000 PLAN O.S. Ref: 5715-A

SCHEDULE PART I : LAND OTHER THAN LAND CONSISTING OF A HOUSE OR HOUSES UNFIT FOR HUMAN HABITATION AND NOT CAPABLE OF BEING RENDERED FIT FOR HUMAN HABITATION AT REASONABLE EXPENSE.

No. on Map Deposited at the Offices of the Local Authority	Area (Ha)	Townland	Electoral District	Description	Owners or Reputed Owners	Lessees or Reputed Lessees	Occupiers
100A	0.0078	Ballygillane Little	St. Helen's	Public Road	Wexford County Council	*	Wexford County Council
100B	0.1417	Ballygillane Little	St. Helen's	Public Road	Wexford County Council	*	Wexford County Council
101A	0.0135	Ballygillane Little	St. Helen's	Public Road	Wexford County Council	*	Wexford County Council
102A	0.0417	Ballygerry	St. Helen's	Agricultural Land	Breda Kelly	*	Breda Kelly
102B	0.0436	Ballygerry	St. Helen's	Agricultural Land	Breda Kelly	*	Breda Kelly
102C	0.9540	Ballygerry	St. Helen's	Public Road	Breda Kelly	*	Wexford County Council
102D	0.0008	Ballygerry	St. Helen's	Public Road	Breda Kelly	*	Wexford County Council
102E	0.0051	Ballygerry	St. Helen's	Private Road	Breda Kelly	*	Breda Kelly
102F	0.0191	Ballygerry	St. Helen's	Agricultural Land	Breda Kelly	*	Breda Kelly
102G	0.0102	Ballygerry	St. Helen's	Land from Commercial Property	Breda Kelly	*	Breda Kelly
103A	0.0021	Ballygerry	St. Helen's	Land from Commercial Property	Irish Water	*	Irish Water
103B	0.0073	Ballygerry	St. Helen's	Public Road	Irish Water	*	Wexford County Council
103C	0.0139	Ballygerry	St. Helen's	Private Road	Irish Water	*	Irish Water
103D	0.0595	Ballygerry	St. Helen's	Private Road	Irish Water	*	Irish Water
103E	0.0069	Ballygerry	St. Helen's	Private Road	Irish Water	*	Irish Water
104A	0.0282	Churchtown	St. Helen's	Agricultural Land	Breda & Pat Heffernan	*	Breda & Pat Heffernan
104B	0.0390	Churchtown	St. Helen's	Public Road	Breda & Pat Heffernan	*	Wexford County Council
105A	0.1219	Ballygerry/Churchtown	St. Helen's	Public Road	National Veh. Distribution LTD	*	Wexford County Council
105B	0.0209	Ballygerry	St. Helen's	Private Road	National Veh. Distribution LTD	*	National Veh. Distribution LTD
105C	0.1900	Churchtown	St. Helen's	Land from Commercial Property	National Veh. Distribution LTD	*	National Veh. Distribution LTD
105D	0.4510	Ballygerry	St. Helen's	Agricultural Land	National Veh. Distribution LTD	*	National Veh. Distribution LTD
106A	0.4337	Ballygerry	St. Helen's	Dwelling and Lands	Anne Gleeson	*	Anne Gleeson
106B	0.0171	Ballygerry	St. Helen's	Private Road	Anne Gleeson	*	Anne Gleeson

Wexford County Council Compulsory Purchase Order No. 9 of 2022, (N25 Rosslare Europort Access Road) in the County of Wexford. The official seal of the Local Authority was affixed hereto this ____ day of ____ 2022 .

____ Chief Executive.
 ____ County Secretary.
 ____ Cathaoirleach.

NOTE:
 Denotes Lands covered by Compulsory Purchase Order

SCHEDULE PART II: DESCRIPTION OF PUBLIC RIGHTS OF WAY PROPOSED TO BE EXTINGUISHED
 The section of Local Road No. L3068 in the Townland of Ballygillane Little and Ballygerry between the lines 1-1 & 1A-1A for a distance of 460m
 The section of Local Road No. L7021 in the Townland of Ballygerry between the lines 2-2 & 2A-2A for a distance of 255m

© Mott MacDonald
 This Document is issued for the party which commissioned it and for specific purposes connected with the captioned party only. It should not be relied upon by any other party or used for any other purpose.
 We accept no responsibility for the consequences of this document being relied upon by any other party, or being used for any other purpose, or containing any error or omission which is due to an error or omission in data supplied to us by other parties.

An Roinn Iompair
 Department of Transport

TII
 Bonneagar Iompair Éireann
 Transport Infrastructure Ireland

Project Ireland 2040
 Building Ireland's Future

Comhairle Contae Loch Garman
 Wexford County Council
 Carricklawn
 Wexford Town

Wexford County Council

M MOTT MACDONALD

Mott MacDonald
 5 Eastgate Avenue
 Eastgate
 Little Island
 Co. Cork

Tel. +353 21 4809800
 www.mottmac.com

Notes
 1. DO NOT SCALE, use figured dimensions only. All dimensions to be checked on site.
 2. All levels are referred to Ordnance Survey Datum, Malin Head.
 3. Drawings co-ordinates are at Irish Grid
 4. This drawing to be read in conjunction with all relevant works requirements specifications and drawings.

Rev.	Date	Drawn	Description	Chk'd	Appr.
A	21/03/22	ME	For Information	JOR	JS
B	12/05/22	ME	For Information	JOR	JS
C	31/05/22	ME	For Information	JOR	JS

N25 Rosslare Europort Access Road

Title: **Compulsory Purchase Order No. 9 of 2022**
 Deposited Map
 Sheet 1 of 2

Status: CPO Drawing No. 229100548-MMD-0000-RE-DR-C-0020

Designed: M.Ebert
 Drawn: M.Ebert
 Checked: J. O'Riordan
 Approved: J. Shinkwin
 Scale at A1: 1:1000

Rev: C

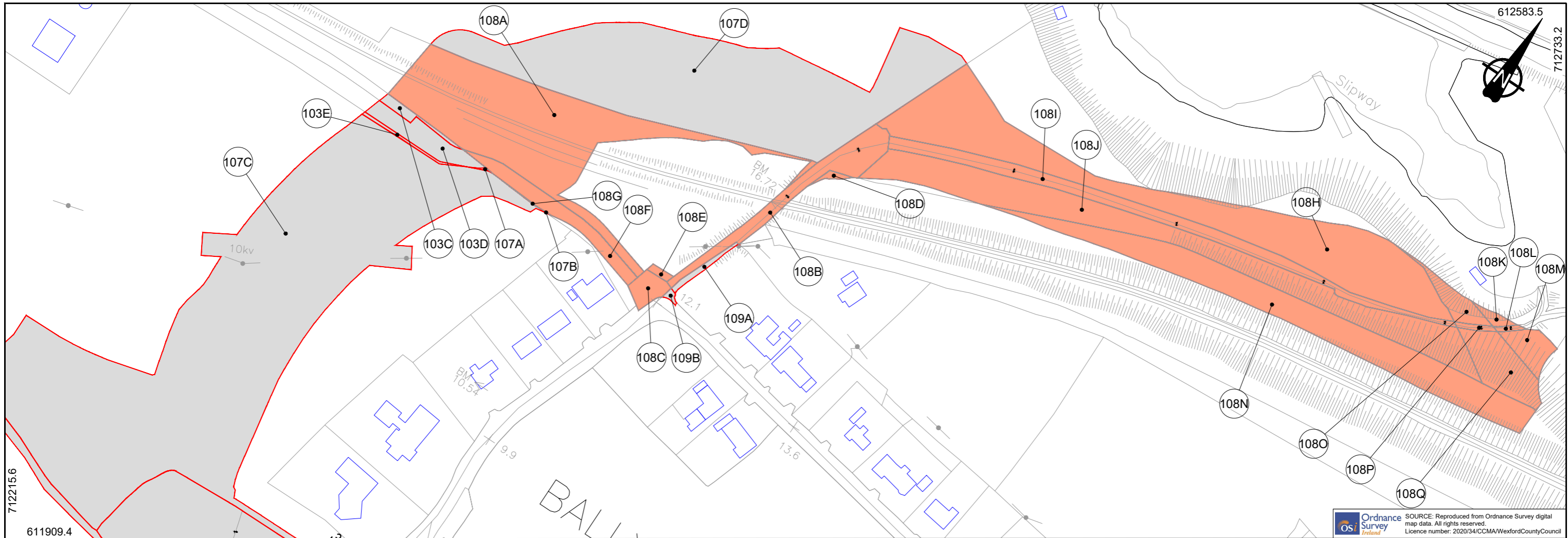

OS Ordnance Survey Ireland SOURCE: Reproduced from Ordnance Survey digital map data. All rights reserved. Licence number: 2020/34/CMA/WexfordCountyCouncil

Plan Scale - 1:1,000

PLAN

O.S. Ref: 5715-A

SCHEDULE PART I : LAND OTHER THAN LAND CONSISTING OF A HOUSE OR HOUSES UNFIT FOR HUMAN HABITATION AND NOT CAPABLE OF BEING RENDERED FIT FOR HUMAN HABITATION AT REASONABLE EXPENSE.

No. on Map Deposited at the Offices of the Local Authority	Area (Ha)	Townland	Electoral District	Description	Owners or Reputed Owners	Lessees or Reputed Lessees	Occupiers
103C	0.0139	Ballygerry	St. Helen's	Private Road	Irish Water	*	Irish Water
103D	0.0595	Ballygerry	St. Helen's	Private Road	Irish Water	*	Irish Water
103E	0.0069	Ballygerry	St. Helen's	Private Road	Irish Water	*	Irish Water
107A	0.0007	Ballygerry	St. Helen's	Private Road	John Paul Kelly	*	John Paul Kelly
107B	0.0002	Ballygerry	St. Helen's	Private Road	John Paul Kelly	*	John Paul Kelly
107C	1.9640	Ballygerry	St. Helen's	Agricultural Land	John Paul Kelly	*	John Paul Kelly
107D	0.9643	Ballygerry	St. Helen's	Agricultural Land	John Paul Kelly	*	John Paul Kelly
108A	0.5344	Ballygerry	St. Helen's	Railway Area	Coras Iompair Eireann (C.I.E)	*	Coras Iompair Eireann (C.I.E)
108B	0.1090	Ballygerry	St. Helen's	Private Road	Coras Iompair Eireann (C.I.E)	*	Coras Iompair Eireann (C.I.E)
108C	0.0252	Ballygerry	St. Helen's	Public Road	Coras Iompair Eireann (C.I.E)	*	Coras Iompair Eireann (C.I.E)
108D	0.0048	Ballygerry	St. Helen's	Railway Area	Coras Iompair Eireann (C.I.E)	*	Coras Iompair Eireann (C.I.E)
108E	0.0051	Ballygerry	St. Helen's	Railway Area	Coras Iompair Eireann (C.I.E)	*	Coras Iompair Eireann (C.I.E)
108F	0.0709	Ballygerry	St. Helen's	Private Road	Coras Iompair Eireann (C.I.E)	*	Coras Iompair Eireann (C.I.E)
108G	0.0005	Ballygerry	St. Helen's	Private Road	Coras Iompair Eireann (C.I.E)	*	Coras Iompair Eireann (C.I.E)
108H	0.6051	Ballygerry	St. Helen's	Private Lands	Coras Iompair Eireann (C.I.E)	*	Coras Iompair Eireann (C.I.E)
108I	0.1653	Ballygerry	St. Helen's	Private Road	Coras Iompair Eireann (C.I.E)	*	Coras Iompair Eireann (C.I.E)
108J	0.4287	Ballygerry	St. Helen's	Private Lands	Coras Iompair Eireann (C.I.E)	*	Coras Iompair Eireann (C.I.E)
108K	0.0091	Ballygerry	St. Helen's	Private Lands	Coras Iompair Eireann (C.I.E)	*	Coras Iompair Eireann (C.I.E)
108L	0.0038	Ballygerry	St. Helen's	Private Road	Coras Iompair Eireann (C.I.E)	*	Coras Iompair Eireann (C.I.E)
108M	0.0384	Ballygerry	St. Helen's	Private Lands	Coras Iompair Eireann (C.I.E)	*	Coras Iompair Eireann (C.I.E)
108N	0.3704	Ballygerry	St. Helen's	Railway Area	Coras Iompair Eireann (C.I.E)	*	Coras Iompair Eireann (C.I.E)
108O	0.0347	Ballygerry	St. Helen's	Private Lands	Coras Iompair Eireann (C.I.E)	*	Coras Iompair Eireann (C.I.E)
108P	0.0058	Ballygerry	St. Helen's	Private Road	Coras Iompair Eireann (C.I.E)	*	Coras Iompair Eireann (C.I.E)
108Q	0.0887	Ballygerry	St. Helen's	Private Lands	Coras Iompair Eireann (C.I.E)	*	Coras Iompair Eireann (C.I.E)
109A	0.0100	Ballygerry	St. Helen's	Private Road	David Michael Laheen	*	David Michael Laheen
109B	0.0027	Ballygerry	St. Helen's	Public Road	David Michael Laheen	*	David Michael Laheen

Wexford County Council Compulsory Purchase Order No. 9 of 2022, (N25 Rosslare Europort Access Road) in the County of Wexford. The official seal of the Local Authority was affixed hereto this ___ day of ___ 2022 .

Chief Executive.

County Secretary.

Cathaoirleach.

NOTE:
 The area shaded orange and outlined in grey is owned by Coras Iompair Eireann. This area forms part of the project road corridor but is not included in the Compulsory Purchase Order and is shown for information only. These lands will be the subject of a separate legal license agreement between CIE and Wexford County Council.

 Denotes Lands covered by Compulsory Purchase Order

© Mott MacDonald
 This Document is issued for the party which commissioned it and for specific purposes connected with the captioned party only. It should not be relied upon by any other party or used for any other purpose.
 We accept no responsibility for the consequences of this document being relied upon by any other party, or being used for any other purpose, or containing any error or omission which is due to an error or omission in data supplied to us by other parties.



- Notes
- DO NOT SCALE, use figured dimensions only. All dimensions to be checked on site.
 - All levels are referred to Ordnance Survey Datum, Malin Head.
 - Drawings co-ordinates are at Irish Grid
 - This drawing to be read in conjunction with all relevant works requirements specifications and drawings.

Rev.	Date	Drawn	Description	Chk'd	Appr.
A	21/03/22	ME	For Information	JOR	JS
B	12/05/22	ME	For Information	JOR	JS

N25 Rosslare Europort Access Road			
Title:	Compulsory Purchase Order No. 9 of 2022		Designed: M.Ebert
Deposited Map	Sheet 2 of 2		Drawn: M.Ebert
Status:	Drawing No.	229100548-MMD-0000-RE-DR-C-0021	Checked: J. O'Riordan
CPO	Rev:	B	Approved: J. Shinkwin
			Scale at A1: 1:1000

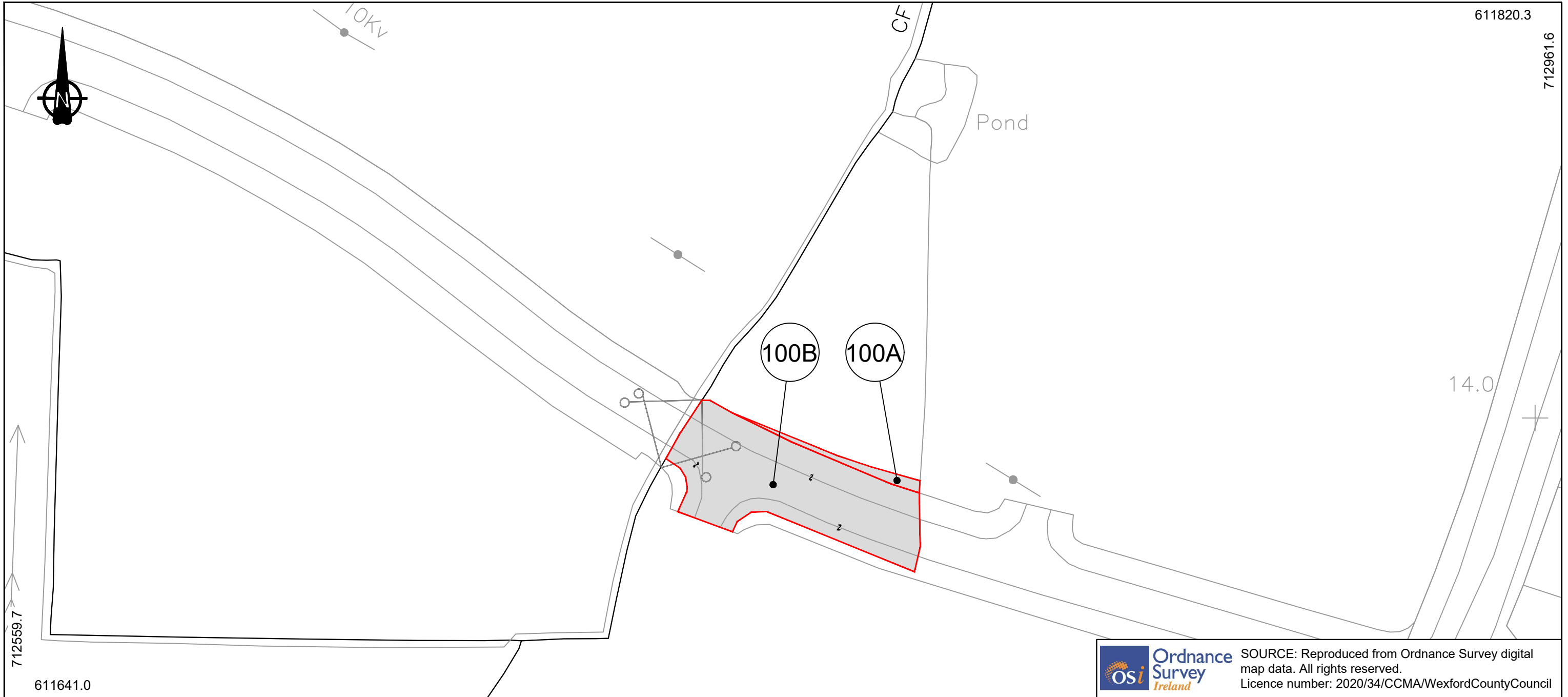

OSi Ordnance Survey Ireland
 SOURCE: Reproduced from Ordnance Survey digital map data. All rights reserved.
 Licence number: 2020/34/CCMA/WexfordCountyCouncil

611641.0 PLAN Scale - 1:1,000 PLAN O.S. Ref: 5715-A

SCHEDULE PART I : LAND OTHER THAN LAND CONSISTING OF A HOUSE OR HOUSES UNFIT FOR HUMAN HABITATION AND NOT CAPABLE OF BEING RENDERED FIT FOR HUMAN HABITATION AT REASONABLE EXPENSE.

No. on Map Deposited at the Offices of the Local Authority	Area (Ha)	Townland	Electoral District	Description	Owners or Reputed Owners	Lessees or Reputed Lessees	Occupiers
100A	0.0078	Ballygillane Little	St. Helen's	Public Road	Wexford County Council	*	Wexford County Council
100B	0.1417	Ballygillane Little	St. Helen's	Public Road	Wexford County Council	*	Wexford County Council

© Mott MacDonald
 This Document is issued for the party which commissioned it and for specific purposes connected with the captioned project only. It should not be relied upon by any other party or used for any other purpose.
 We accept no responsibility for the consequences of this document being relied upon by any other party, or being used for any other purpose, or containing any error or omission which is due to an error or omission in data supplied to us by other parties.

NOTE:
 Denotes Lands covered by Compulsory Purchase Order

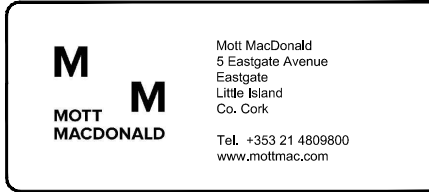

Notes
 1. DO NOT SCALE, use figured dimensions only. All dimensions to be checked on site.
 2. All levels are referred to Ordnance Survey Datum, Malin Head.
 3. Drawings co-ordinates are at Irish Grid
 4. This drawing to be read in conjunction with all relevant works requirements specifications and drawings.

Rev.	Date	Drawn	Description	Chk'd	Appr.
A	21/03/2022	ME	For Information	JOR	JS
B	12/05/2022	ME	For Information	JOR	JS

N25 Rosslare Europort Access Road

Title: Lands to be Compulsorily Acquired
 Wexford County Council
 C.P.O. Plot No's 100A & 100B

Designed: M.Ebert
 Drawn: M.Ebert
 Checked: J. O'Riordan
 Approved: J. Shinkwin
 Scale at A3: 1:1000

Status: CPO Drawing No.: 229100548-MMD-0000-RE-DR-C-0022 Rev: B

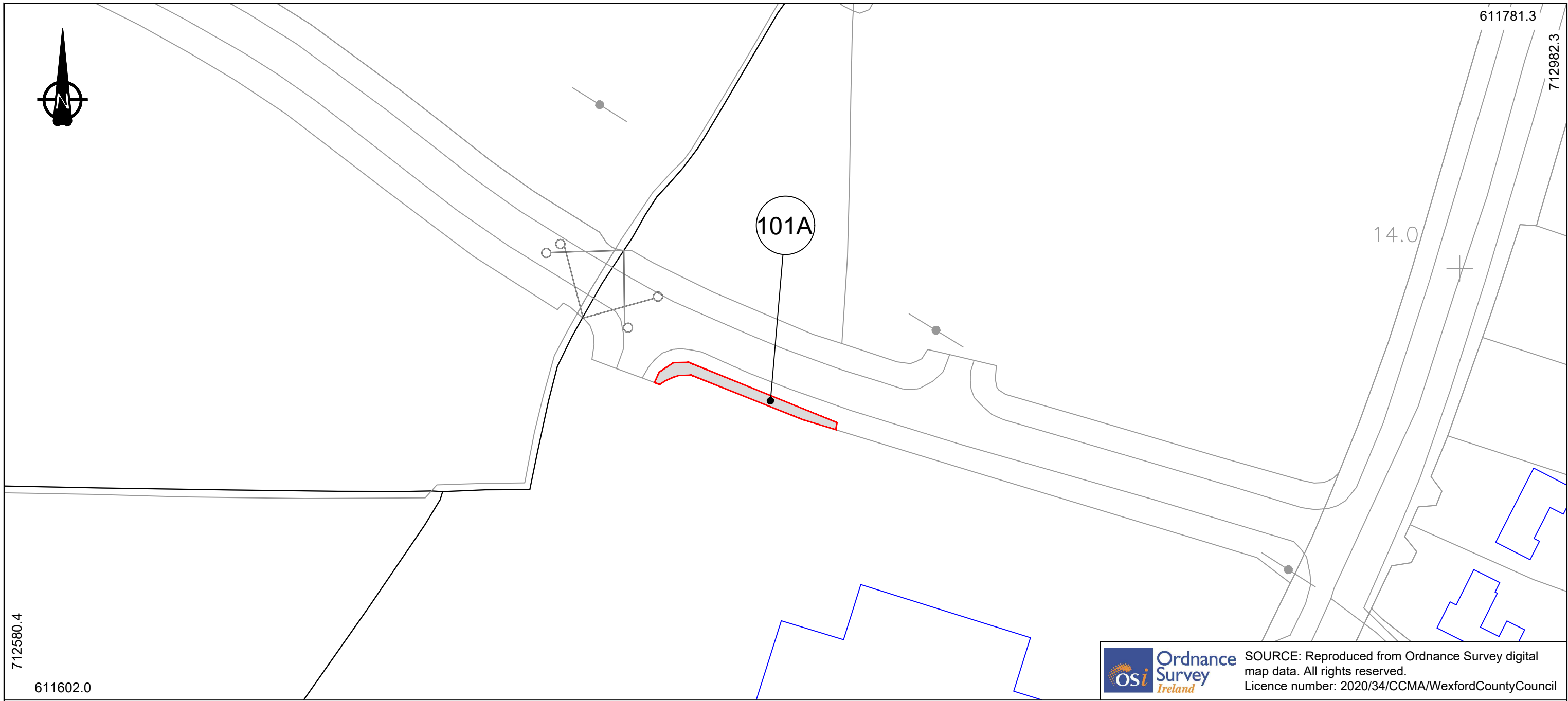

SOURCE: Reproduced from Ordnance Survey digital map data. All rights reserved.
Licence number: 2020/34/CCMA/WexfordCountyCouncil

Plan Scale - 1:1,000 PLAN O.S. Ref: 5715-A

SCHEDULE PART I : LAND OTHER THAN LAND CONSISTING OF A HOUSE OR HOUSES UNFIT FOR HUMAN HABITATION AND NOT CAPABLE OF BEING RENDERED FIT FOR HUMAN HABITATION AT REASONABLE EXPENSE.

No. on Map Deposited at the Offices of the Local Authority	Area (Ha)	Townland	Electoral District	Description	Owners or Reputed Owners	Lessees or Reputed Lessees	Occupiers
101A	0.0135	Ballygillane Little	St. Helen's	Public Road	Wexford County Council	*	Wexford County Council

© Mott MacDonald
This Document is issued for the party which commissioned it and for specific purposes connected with the captioned project only. It should not be relied upon by any other party or used for any other purpose.
We accept no responsibility for the consequences of this document being relied upon by any other party, or being used for any other purpose, or containing any error or omission which is due to an error or omission in data supplied to us by other parties.

NOTE:
 Denotes Lands covered by Compulsory Purchase Order



M M
MOTT MACDONALD
Mott MacDonald
5 Eastgate Avenue
Eastgate
Little Island
Co. Cork
Tel. +353 21 4809800
www.mottmac.com

Notes
1. DO NOT SCALE, use figured dimensions only. All dimensions to be checked on site.
2. All levels are referred to Ordnance Survey Datum, Malin Head.
3. Drawings co-ordinates are at Irish Grid
4. This drawing to be read in conjunction with all relevant works requirements specifications and drawings.

Rev.	Date	Drawn	Description	Chk'd	Appr.
A	21/03/2022	ME	For Information	JOR	JS
B	12/05/2022	ME	For Information	JOR	JS

N25 Rosslare Europort Access Road

Title: **Lands to be Compulsorily Acquired**
Wexford County Council
C.P.O. Plot No. 101A

Designed:	M.Ebert
Drawn:	M.Ebert
Checked:	J. O'Riordan
Approved:	J. Shinkwin
Scale at A3	1:1000

Status: CPO Drawing No. 229100548-MMD-0000-RE-DR-C-0023 Rev: B

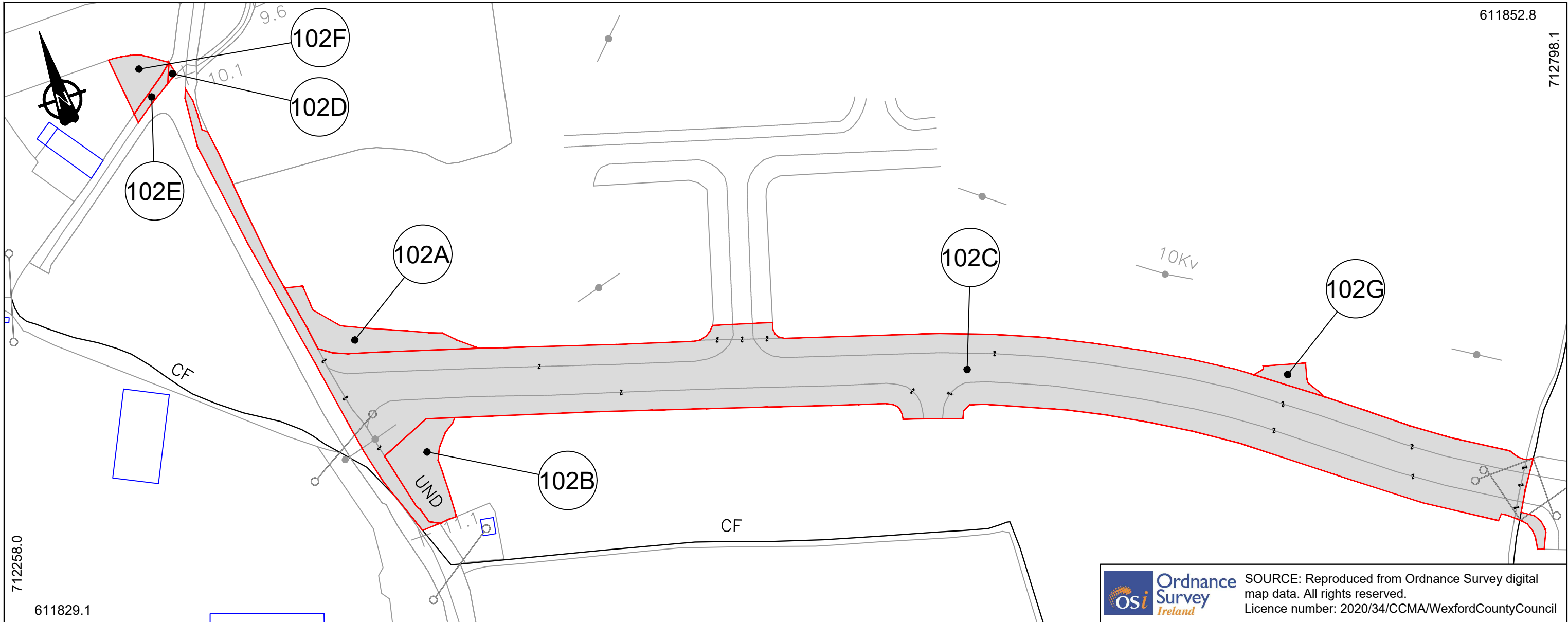

Plan Scale - 1:1,250

PLAN

O.S. Ref: 5715-A

SCHEDULE PART I : LAND OTHER THAN LAND CONSISTING OF A HOUSE OR HOUSES UNFIT FOR HUMAN HABITATION AND NOT CAPABLE OF BEING RENDERED FIT FOR HUMAN HABITATION AT REASONABLE EXPENSE.

No. on Map Deposited at the Offices of the Local Authority	Area (Ha)	Townland	Electoral District	Description	Owners or Reputed Owners	Lessees or Reputed Lessees	Occupiers
102A	0.0417	Ballygerry	St. Helen's	Agricultural Land	Breda Kelly	*	Breda Kelly
102B	0.0436	Ballygerry	St. Helen's	Agricultural Land	Breda Kelly	*	Breda Kelly
102C	0.9540	Ballygerry	St. Helen's	Public Road	Breda Kelly	*	Wexford County Council
102D	0.0008	Ballygerry	St. Helen's	Public Road	Breda Kelly	*	Wexford County Council
102E	0.0051	Ballygerry	St. Helen's	Private Road	Breda Kelly	*	Breda Kelly
102F	0.0191	Ballygerry	St. Helen's	Agricultural Land	Breda Kelly	*	Breda Kelly
102G	0.0102	Ballygerry	St. Helen's	Land from Commercial Property	Breda Kelly	*	Breda Kelly

© Mott MacDonald

This Document is issued for the party which commissioned it and for specific purposes connected with the captioned project only. It should not be relied upon by any other party or used for any other purpose. We accept no responsibility for the consequences of this document being relied upon by any other party, or being used for any other purpose, or containing any error or omission which is due to an error or omission in data supplied to us by other parties.

NOTE:
 Denotes Lands covered by Compulsory Purchase Order



Notes
 1. DO NOT SCALE, use figured dimensions only. All dimensions to be checked on site.
 2. All levels are referred to Ordnance Survey Datum, Malin Head.
 3. Drawings co-ordinates are at Irish Grid
 4. This drawing to be read in conjunction with all relevant works requirements specifications and drawings.

Rev.	Date	Drawn	Description	Chk'd	Appr.
A	21/03/2022	ME	For Information	JOR	JS
B	12/05/2022	ME	For Information	JOR	JS

N25 Rosslare Europort Access Road	
Title:	Lands to be Compulsorily Acquired Breda Kelly C.P.O. Plot No's 102A to 102G
Designed:	M.Ebert
Drawn:	M.Ebert
Checked:	J. O'Riordan
Approved:	J. Shinkwin
Status:	CPO
Drawing No.:	229100548-MMD-0000-RE-DR-C-0024
Scale at A3:	1:1250
Rev:	B

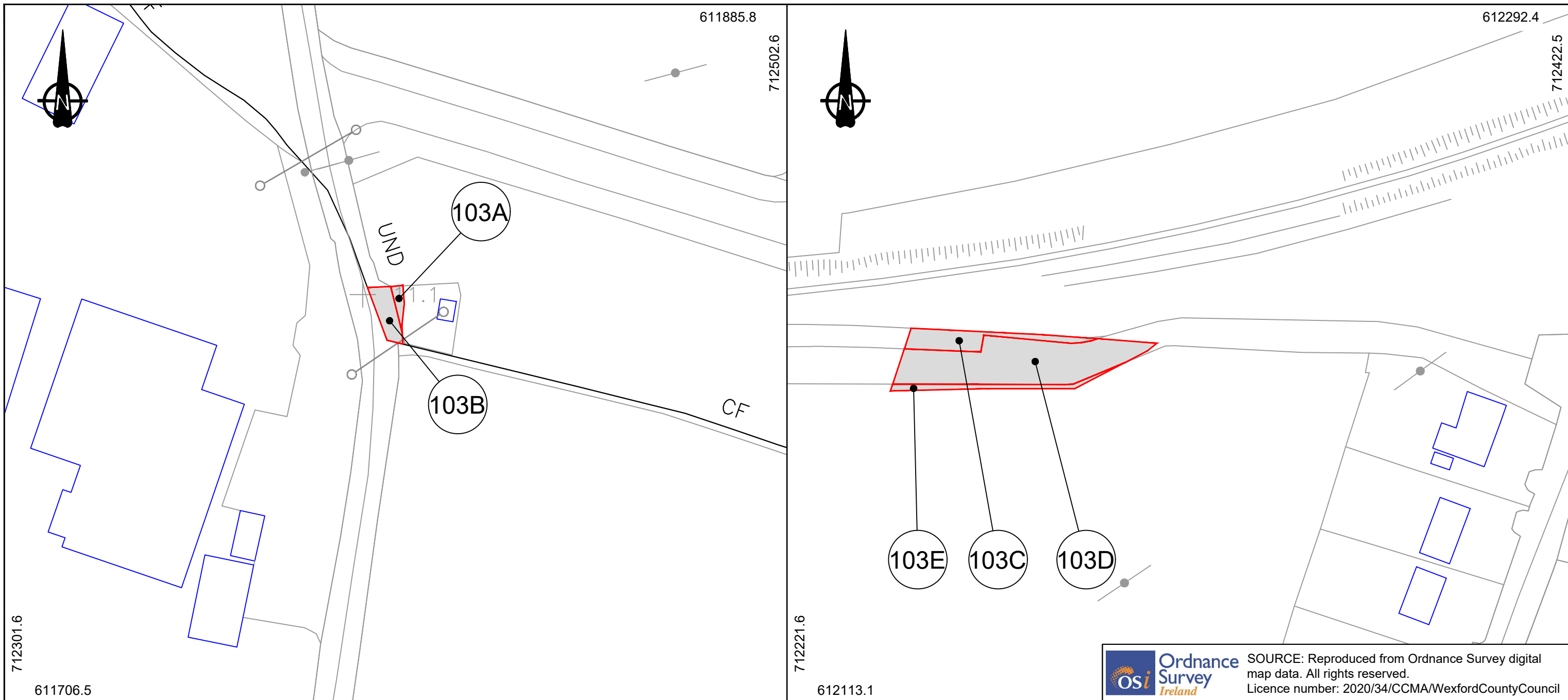



Ordnance Survey Ireland
 SOURCE: Reproduced from Ordnance Survey digital map data. All rights reserved.
 Licence number: 2020/34/CCMA/WexfordCountyCouncil

Plan Scale - 1:1,000 PLAN O.S. Ref: 5715-A

SCHEDULE PART I : LAND OTHER THAN LAND CONSISTING OF A HOUSE OR HOUSES UNFIT FOR HUMAN HABITATION AND NOT CAPABLE OF BEING RENDERED FIT FOR HUMAN HABITATION AT REASONABLE EXPENSE.

No. on Map Deposited at the Offices of the Local Authority	Area (Ha)	Townland	Electoral District	Description	Owners or Reputed Owners	Lessees or Reputed Lessees	Occupiers
103A	0.0021	Ballygerry	St. Helen's	Land from Commercial Property	Irish Water	*	Irish Water
103B	0.0073	Ballygerry	St. Helen's	Public Road	Irish Water	*	Wexford County Council
103C	0.0139	Ballygerry	St. Helen's	Private Road	Irish Water	*	Irish Water
103D	0.0595	Ballygerry	St. Helen's	Private Road	Irish Water	*	Irish Water
103E	0.0069	Ballygerry	St. Helen's	Private Road	Irish Water	*	Irish Water

© Mott MacDonald
 This Document is issued for the party which commissioned it and for specific purposes connected with the captioned project only. It should not be relied upon by any other party or used for any other purpose.
 We accept no responsibility for the consequences of this document being relied upon by any other party, or being used for any other purpose, or containing any error or omission which is due to an error or omission in data supplied to us by other parties.

NOTE:
 Denotes Lands covered by Compulsory Purchase Order

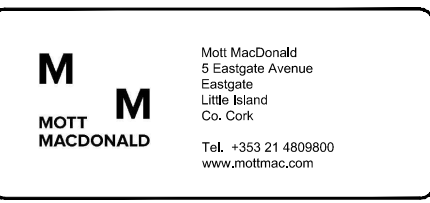

Notes
 1. DO NOT SCALE, use figured dimensions only. All dimensions to be checked on site.
 2. All levels are referred to Ordnance Survey Datum, Malin Head.
 3. Drawings co-ordinates are at Irish Grid
 4. This drawing to be read in conjunction with all relevant works requirements specifications and drawings.

Rev.	Date	Drawn	Description	Chk'd	Appr.
A	22/03/2022	ME	For Information	JOR	JS
B	12/05/2022	ME	For Information	JOR	JS

N25 Rosslare Europort Access Road	
Title:	Lands to be Compulsorily Acquired Irish Water C.P.O. Plot No's 103A to 103E
Designed:	M.Ebert
Drawn:	M.Ebert
Checked:	J. O'Riordan
Approved:	J. Shinkwin
Status:	CPO
Drawing No.:	229100548-MMD-0000-RE-DR-C-0025
Scale at A3:	1:1000
Rev:	B

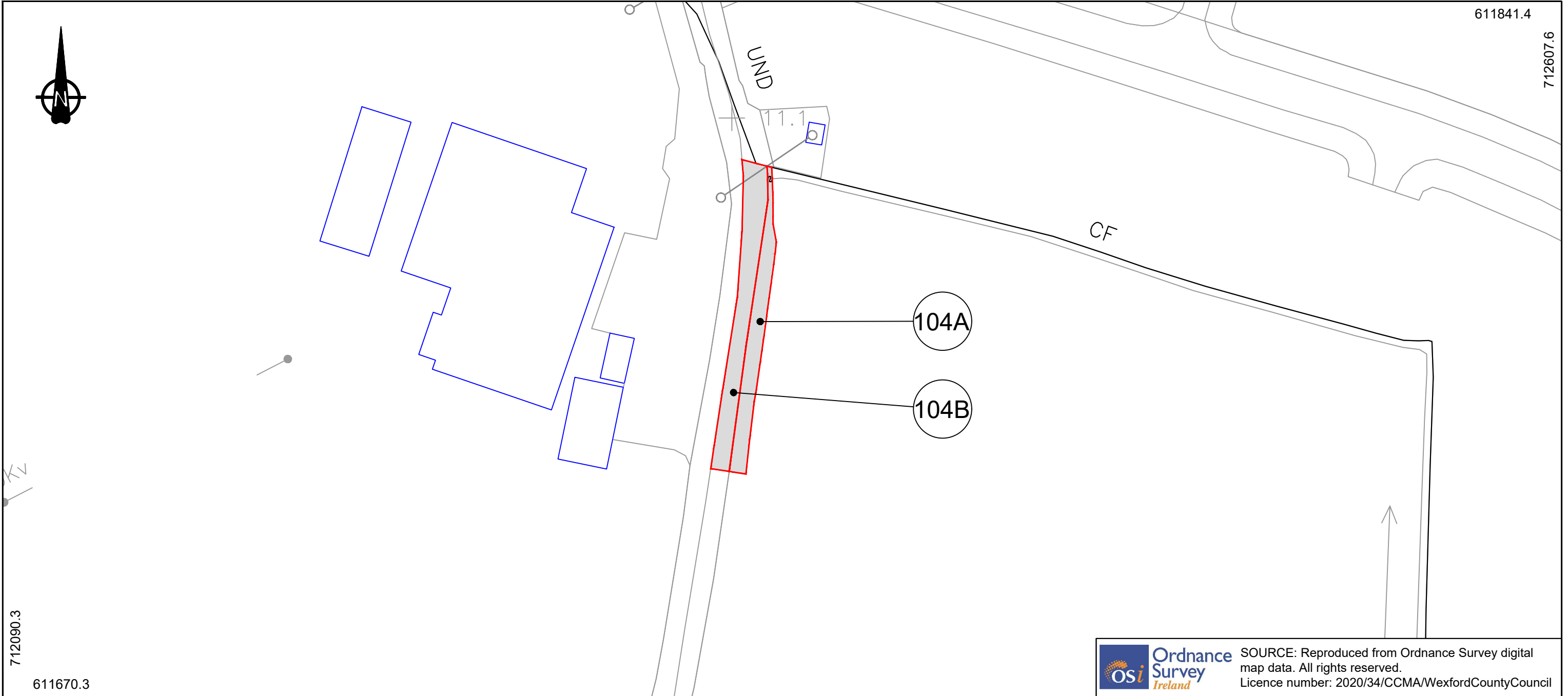

OSi Ordnance Survey Ireland
 SOURCE: Reproduced from Ordnance Survey digital map data. All rights reserved.
 Licence number: 2020/34/CCMA/WexfordCountyCouncil

611670.3
 Plan Scale - 1:1,000
 PLAN
 O.S. Ref: 5715-A

SCHEDULE PART I : LAND OTHER THAN LAND CONSISTING OF A HOUSE OR HOUSES UNFIT FOR HUMAN HABITATION AND NOT CAPABLE OF BEING RENDERED FIT FOR HUMAN HABITATION AT REASONABLE EXPENSE.

No. on Map Deposited at the Offices of the Local Authority	Area (Ha)	Townland	Electoral District	Description	Owners or Reputed Owners	Lessees or Reputed Lessees	Occupiers
104A	0.0282	Churchtown	St. Helen's	Agricultural Land	Breda & Pat Heffernan	*	Breda & Pat Heffernan
104B	0.0390	Churchtown	St. Helen's	Public Road	Breda & Pat Heffernan	*	Wexford County Council

© Mott MacDonald
 This Document is issued for the party which commissioned it and for specific purposes connected with the captioned project only. It should not be relied upon by any other party or used for any other purpose.
 We accept no responsibility for the consequences of this document being relied upon by any other party, or being used for any other purpose, or containing any error or omission which is due to an error or omission in data supplied to us by other parties.

NOTE:
 Denotes Lands covered by Compulsory Purchase Order

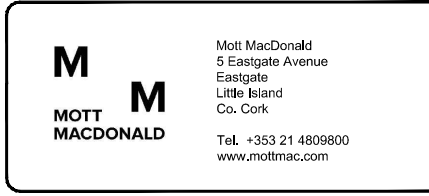

Notes
 1. DO NOT SCALE, use figured dimensions only. All dimensions to be checked on site.
 2. All levels are referred to Ordnance Survey Datum, Malin Head.
 3. Drawings co-ordinates are at Irish Grid
 4. This drawing to be read in conjunction with all relevant works requirements specifications and drawings.

Rev.	Date	Drawn	Description	Chk'd	Appr.
A	21/03/2022	ME	For Information	JOR	JS
B	12/05/2022	ME	For Information	JOR	JS

N25 Rosslare Europort Access Road	
Title:	Lands to be Compulsorily Acquired Breda & Pat Heffernan C.P.O. Plot No's 104A & 104B
Designed:	M.Ebert
Drawn:	M.Ebert
Checked:	J. O'Riordan
Approved:	J. Shinkwin
Scale at A3	1:1000
Status	CPO
Drawing No.	229100548-MMD-0000-RE-DR-C-0026
Rev:	B

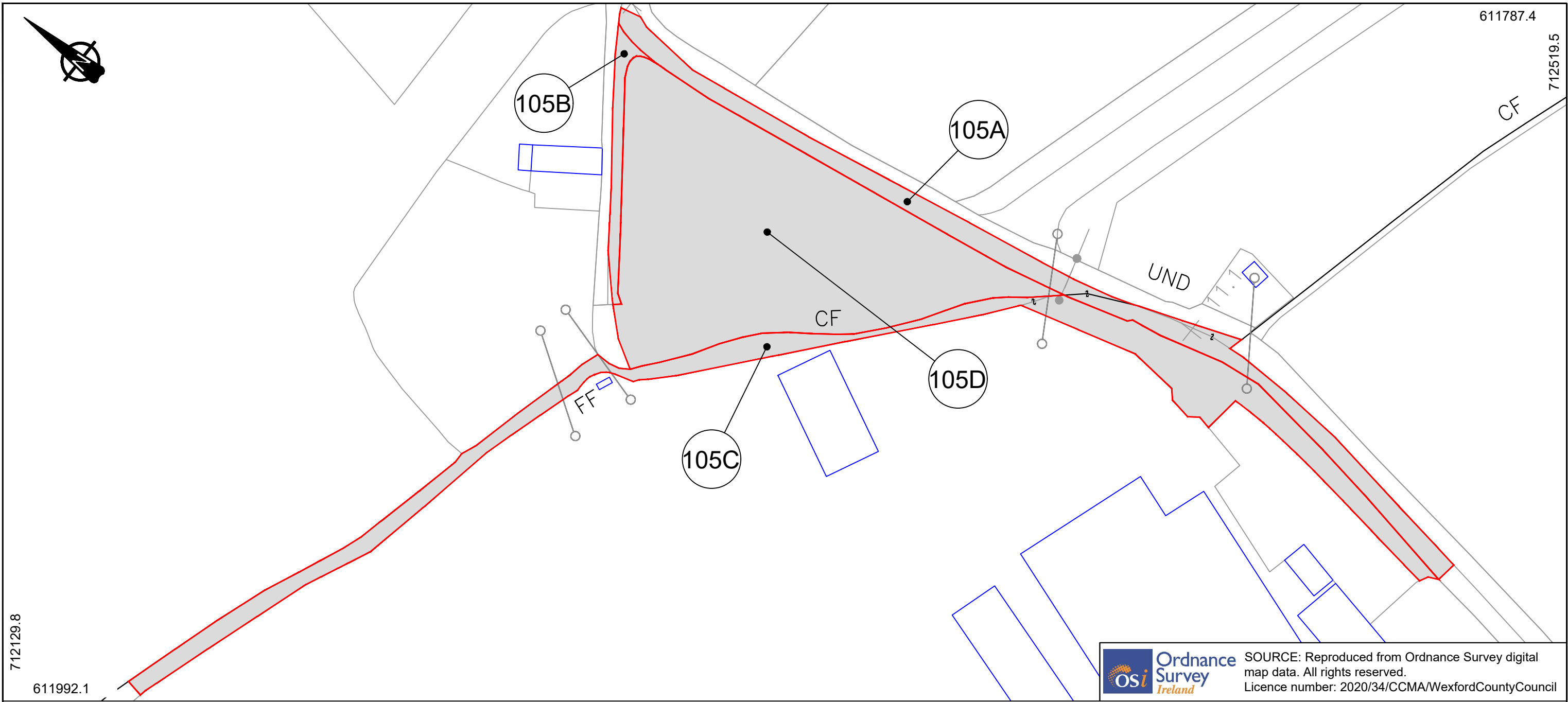

Plan Scale - 1:1,000 PLAN O.S. Ref: 5715-A

SCHEDULE PART I : LAND OTHER THAN LAND CONSISTING OF A HOUSE OR HOUSES UNFIT FOR HUMAN HABITATION AND NOT CAPABLE OF BEING RENDERED FIT FOR HUMAN HABITATION AT REASONABLE EXPENSE.

No. on Map Deposited at the Offices of the Local Authority	Area (Ha)	Townland	Electoral District	Description	Owners or Reputed Owners	Lessees or Reputed Lessees	Occupiers
105A	0.1219	Ballygerry/Churchtown	St. Helen's	Public Road	National Veh. Distribution LTD	*	Wexford County Council
105B	0.0209	Ballygerry	St. Helen's	Private Road	National Veh. Distribution LTD	*	National Veh. Distribution LTD
105C	0.1900	Churchtown	St. Helen's	Land from Commercial Property	National Veh. Distribution LTD	*	National Veh. Distribution LTD
105D	0.4510	Ballygerry	St. Helen's	Agricultural Land	National Veh. Distribution LTD	*	National Veh. Distribution LTD

© Mott MacDonald
 This Document is issued for the party which commissioned it and for specific purposes connected with the captioned project only. It should not be relied upon by any other party or used for any other purpose.
 We accept no responsibility for the consequences of this document being relied upon by any other party, or being used for any other purpose, or containing any error or omission which is due to an error or omission in data supplied to us by other parties.

NOTE:
 Denotes Lands covered by Compulsory Purchase Order

 An Roinn Iompair Department of Transport	 TII Bonneagar Iompair Eireann Transport Infrastructure Ireland	 Comhairle Contae Loch Garman Wexford County Council Carricklawn Wexford Town	 MOTT MACDONALD Mott MacDonald 5 Eastgate Avenue Eastgate Little Island Co. Cork Tel. +353 21 4809800 www.mottmac.com	Notes 1. DO NOT SCALE, use figured dimensions only. All dimensions to be checked on site. 2. All levels are referred to Ordnance Survey Datum, Malin Head. 3. Drawings co-ordinates are at Irish Grid 4. This drawing to be read in conjunction with all relevant works requirements specifications and drawings.	<table border="1" style="width: 100%; border-collapse: collapse;"> <thead> <tr> <th>Rev.</th> <th>Date</th> <th>Drawn</th> <th>Description</th> <th>Chk'd</th> <th>Appr.</th> </tr> </thead> <tbody> <tr> <td>A</td> <td>22/03/2022</td> <td>ME</td> <td>For Information</td> <td>JOR</td> <td>JS</td> </tr> <tr> <td>B</td> <td>12/05/2022</td> <td>ME</td> <td>For Information</td> <td>JOR</td> <td>JS</td> </tr> </tbody> </table>	Rev.	Date	Drawn	Description	Chk'd	Appr.	A	22/03/2022	ME	For Information	JOR	JS	B	12/05/2022	ME	For Information	JOR	JS	<table border="1" style="width: 100%; border-collapse: collapse;"> <thead> <tr> <th colspan="2">N25 Rosslare Europort Access Road</th> </tr> </thead> <tbody> <tr> <td>Title:</td> <td>Lands to be Compulsorily Acquired National Veh. Distribution LTD C.P.O. Plot No's 105A to 105D</td> </tr> <tr> <td>Designed:</td> <td>M.Ebert</td> </tr> <tr> <td>Drawn:</td> <td>M.Ebert</td> </tr> <tr> <td>Checked:</td> <td>J. O'Riordan</td> </tr> <tr> <td>Approved:</td> <td>J. Shinkwin</td> </tr> <tr> <td>Scale at A3</td> <td>1:1000</td> </tr> <tr> <td>Status:</td> <td>CPO</td> </tr> <tr> <td>Drawing No.</td> <td>229100548-MMD-0000-RE-DR-C-0027</td> </tr> <tr> <td>Rev:</td> <td>B</td> </tr> </tbody> </table>	N25 Rosslare Europort Access Road		Title:	Lands to be Compulsorily Acquired National Veh. Distribution LTD C.P.O. Plot No's 105A to 105D	Designed:	M.Ebert	Drawn:	M.Ebert	Checked:	J. O'Riordan	Approved:	J. Shinkwin	Scale at A3	1:1000	Status:	CPO	Drawing No.	229100548-MMD-0000-RE-DR-C-0027	Rev:	B
Rev.	Date	Drawn	Description	Chk'd	Appr.																																							
A	22/03/2022	ME	For Information	JOR	JS																																							
B	12/05/2022	ME	For Information	JOR	JS																																							
N25 Rosslare Europort Access Road																																												
Title:	Lands to be Compulsorily Acquired National Veh. Distribution LTD C.P.O. Plot No's 105A to 105D																																											
Designed:	M.Ebert																																											
Drawn:	M.Ebert																																											
Checked:	J. O'Riordan																																											
Approved:	J. Shinkwin																																											
Scale at A3	1:1000																																											
Status:	CPO																																											
Drawing No.	229100548-MMD-0000-RE-DR-C-0027																																											
Rev:	B																																											

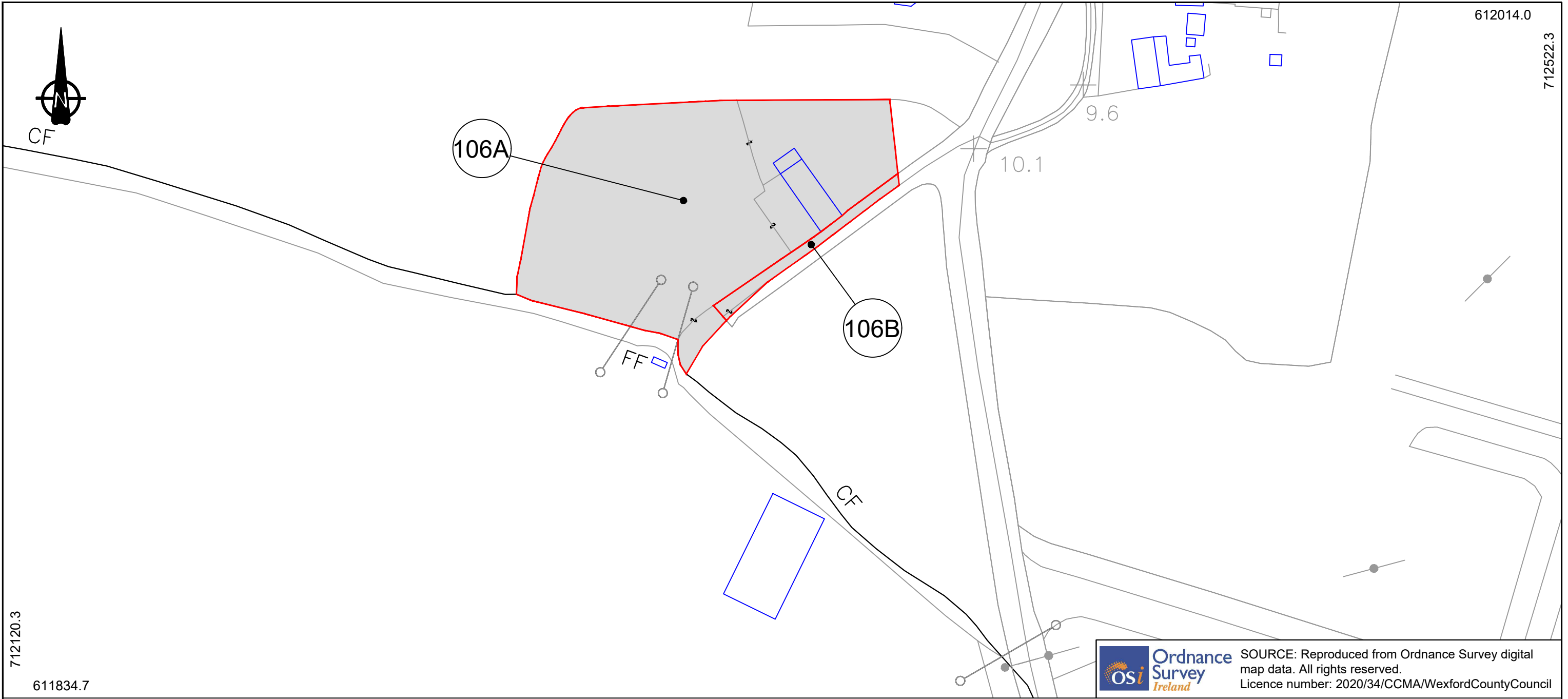

712120.3

611834.7



SOURCE: Reproduced from Ordnance Survey digital map data. All rights reserved.
Licence number: 2020/34/CCMA/WexfordCountyCouncil

Plan Scale - 1:1,000

PLAN

O.S. Ref: 5715-A

SCHEDULE PART I : LAND OTHER THAN LAND CONSISTING OF A HOUSE OR HOUSES UNFIT FOR HUMAN HABITATION AND NOT CAPABLE OF BEING RENDERED FIT FOR HUMAN HABITATION AT REASONABLE EXPENSE.

No. on Map Deposited at the Offices of the Local Authority	Area (Ha)	Townland	Electoral District	Description	Owners or Reputed Owners	Lessees or Reputed Lessees	Occupiers
106A	0.4337	Ballygerry	St. Helen's	Dwelling and Lands	Anne Gleeson	*	Anne Gleeson
106B	0.0171	Ballygerry	St. Helen's	Private Road	Anne Gleeson	*	Anne Gleeson

© Mott MacDonald

This Document is issued for the party which commissioned it and for specific purposes connected with the captioned project only. It should not be relied upon by any other party or used for any other purpose. We accept no responsibility for the consequences of this document being relied upon by any other party, or being used for any other purpose, or containing any error or omission which is due to an error or omission in data supplied to us by other parties.

NOTE:
 Denotes Lands covered by Compulsory Purchase Order



Notes
 1. DO NOT SCALE, use figured dimensions only. All dimensions to be checked on site.
 2. All levels are referred to Ordnance Survey Datum, Malin Head.
 3. Drawings co-ordinates are at Irish Grid
 4. This drawing to be read in conjunction with all relevant works requirements specifications and drawings.

Rev.	Date	Drawn	Description	Chk'd	Appr.
A	22/03/2022	ME	For Information	JOR	JS
B	12/05/2022	ME	For Information	JOR	JS
C	31/05/2022	ME	For Information	JOR	JS

N25 Rosslare Europort Access Road	
Title:	Lands to be Compulsorily Acquired Anne Gleeson C.P.O. Plot No's 106A & 106B
Designed:	M.Ebert
Drawn:	M.Ebert
Checked:	J. O'Riordan
Approved:	J. Shinkwin
Status:	CPO
Drawing No.:	229100548-MMD-0000-RE-DR-C-0028
Scale at A3:	1:1000
Rev:	C

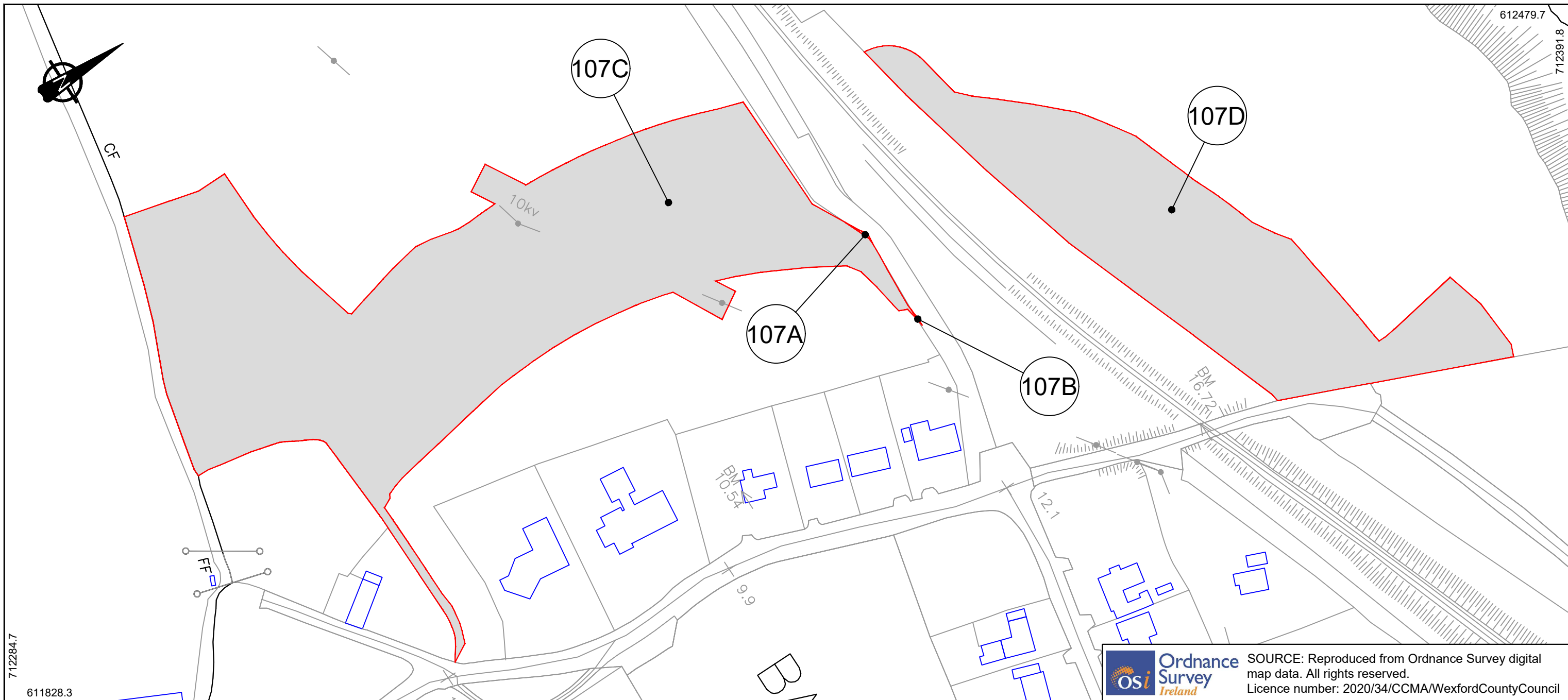

SOURCE: Reproduced from Ordnance Survey digital map data. All rights reserved.
Licence number: 2020/34/CCMA/WexfordCountyCouncil

Plan Scale - 1:1,500 O.S. Ref: 5715-A

SCHEDULE PART I : LAND OTHER THAN LAND CONSISTING OF A HOUSE OR HOUSES UNFIT FOR HUMAN HABITATION AND NOT CAPABLE OF BEING RENDERED FIT FOR HUMAN HABITATION AT REASONABLE EXPENSE.

No. on Map Deposited at the Offices of the Local Authority	Area (Ha)	Townland	Electoral District	Description	Owners or Reputed Owners	Lessees or Reputed Lessees	Occupiers
107A	0.0007	Ballygerry	St. Helen's	Private Road	John Paul Kelly	*	John Paul Kelly
107B	0.0002	Ballygerry	St. Helen's	Private Road	John Paul Kelly	*	John Paul Kelly
107C	1.9640	Ballygerry	St. Helen's	Agricultural Land	John Paul Kelly	*	John Paul Kelly
107D	0.9643	Ballygerry	St. Helen's	Agricultural Land	John Paul Kelly	*	John Paul Kelly

© Mott MacDonald
 This Document is issued for the party which commissioned it and for specific purposes connected with the captioned project only. It should not be relied upon by any other party or used for any other purpose.
 We accept no responsibility for the consequences of this document being relied upon by any other party, or being used for any other purpose, or containing any error or omission which is due to an error or omission in data supplied to us by other parties.

NOTE:
 Denotes Lands covered by Compulsory Purchase Order

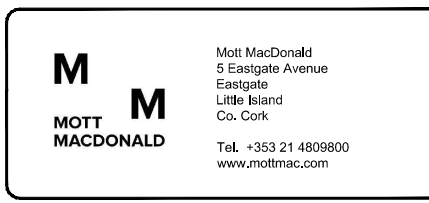

Notes
 1. DO NOT SCALE, use figured dimensions only. All dimensions to be checked on site.
 2. All levels are referred to Ordnance Survey Datum, Malin Head.
 3. Drawings co-ordinates are at Irish Grid
 4. This drawing to be read in conjunction with all relevant works requirements specifications and drawings.

Rev.	Date	Drawn	Description	Chk'd	Appr.
A	22/03/2022	ME	For Information	JOR	JS
B	12/05/2022	ME	For Information	JOR	JS

N25 Rosslare Europort Access Road	
Title:	Lands to be Compulsorily Acquired John Paul Kelly C.P.O. Plot No's 107A to 107D
Designed:	M.Ebert
Drawn:	M.Ebert
Checked:	J. O'Riordan
Approved:	J. Shinkwin
Status:	CPO
Drawing No.:	229100548-MMD-0000-RE-DR-C-0029
Scale at A3:	1:1500
Rev:	B





Ordnance Survey Ireland
 SOURCE: Reproduced from Ordnance Survey digital map data. All rights reserved.
 Licence number: 2020/34/CCMA/WexfordCountyCouncil
 O.S. Ref: 5715-A

Plan Scale - 1:1,500 PLAN O.S. Ref: 5715-A

SCHEDULE PART I : LAND OTHER THAN LAND CONSISTING OF A HOUSE OR HOUSES UNFIT FOR HUMAN HABITATION AND NOT CAPABLE OF BEING RENDERED FIT FOR HUMAN HABITATION AT REASONABLE EXPENSE.

No. on Map Deposited at the Offices of the Local Authority	Area (Ha)	Townland	Electoral District	Description	Owners or Reputed Owners	Lessees or Reputed Lessees	Occupiers
108A	0.5344	Ballygerry	St. Helen's	Railway Area	Coras Iompair Eireann (C.I.E)	*	Coras Iompair Eireann (C.I.E)
108B	0.1090	Ballygerry	St. Helen's	Private Road	Coras Iompair Eireann (C.I.E)	*	Coras Iompair Eireann (C.I.E)
108C	0.0252	Ballygerry	St. Helen's	Public Road	Coras Iompair Eireann (C.I.E)	*	Coras Iompair Eireann (C.I.E)
108D	0.0048	Ballygerry	St. Helen's	Railway Area	Coras Iompair Eireann (C.I.E)	*	Coras Iompair Eireann (C.I.E)
108E	0.0051	Ballygerry	St. Helen's	Railway Area	Coras Iompair Eireann (C.I.E)	*	Coras Iompair Eireann (C.I.E)
108F	0.0709	Ballygerry	St. Helen's	Private Road	Coras Iompair Eireann (C.I.E)	*	Coras Iompair Eireann (C.I.E)
108G	0.0005	Ballygerry	St. Helen's	Private Road	Coras Iompair Eireann (C.I.E)	*	Coras Iompair Eireann (C.I.E)
108H	0.6051	Ballygerry	St. Helen's	Private Lands	Coras Iompair Eireann (C.I.E)	*	Coras Iompair Eireann (C.I.E)
108I	0.1653	Ballygerry	St. Helen's	Private Road	Coras Iompair Eireann (C.I.E)	*	Coras Iompair Eireann (C.I.E)
108J	0.4287	Ballygerry	St. Helen's	Private Lands	Coras Iompair Eireann (C.I.E)	*	Coras Iompair Eireann (C.I.E)
108K	0.0091	Ballygerry	St. Helen's	Private Lands	Coras Iompair Eireann (C.I.E)	*	Coras Iompair Eireann (C.I.E)
108L	0.0038	Ballygerry	St. Helen's	Private Road	Coras Iompair Eireann (C.I.E)	*	Coras Iompair Eireann (C.I.E)
108M	0.0384	Ballygerry	St. Helen's	Private Lands	Coras Iompair Eireann (C.I.E)	*	Coras Iompair Eireann (C.I.E)
108N	0.3704	Ballygerry	St. Helen's	Railway Area	Coras Iompair Eireann (C.I.E)	*	Coras Iompair Eireann (C.I.E)
108O	0.0347	Ballygerry	St. Helen's	Private Lands	Coras Iompair Eireann (C.I.E)	*	Coras Iompair Eireann (C.I.E)
108P	0.0058	Ballygerry	St. Helen's	Private Road	Coras Iompair Eireann (C.I.E)	*	Coras Iompair Eireann (C.I.E)
108Q	0.0887	Ballygerry	St. Helen's	Private Lands	Coras Iompair Eireann (C.I.E)	*	Coras Iompair Eireann (C.I.E)

NOTE:
 The area shaded orange and outlined in grey is owned by Coras Iompair Eireann. This area forms part of the project road corridor but is not included in the Compulsory Purchase Order and is shown for information only. These lands will be the subject of a separate legal license agreement between CIE and Wexford County Council.
 Denotes Lands covered by Compulsory Purchase Order

© Mott MacDonald
 This Document is issued for the party which commissioned it and for specific purposes connected with the captioned project only. It should not be relied upon by any other party or used for any other purpose.
 We accept no responsibility for the consequences of this document being relied upon by any other party, or being used for any other purpose, or containing any error or omission which is due to an error or omission in data supplied to us by other parties.



Notes
 1. DO NOT SCALE, use figured dimensions only. All dimensions to be checked on site.
 2. All levels are referred to Ordnance Survey Datum, Malin Head.
 3. Drawings co-ordinates are at Irish Grid
 4. This drawing to be read in conjunction with all relevant works requirements specifications and drawings.

Rev.	Date	Drawn	Description	Chk'd	Appr.
A	22/03/2022	ME	For Information	JOR	JS
B	12/05/2022	ME	For Information	JOR	JS

N25 Rosslare Europort Access Road

Title: **Lands to be Compulsorily Acquired Coras Iompair Eireann (C.I.E) C.P.O. Plot No's 108A to 108Q**

Status: CPO Drawing No: 229100548-MMD-0000-RE-DR-C-0030 Rev: B

Designed: M.Ebert
 Drawn: M.Ebert
 Checked: J. O'Riordan
 Approved: J. Shinkwin
 Scale at A3: 1:1500

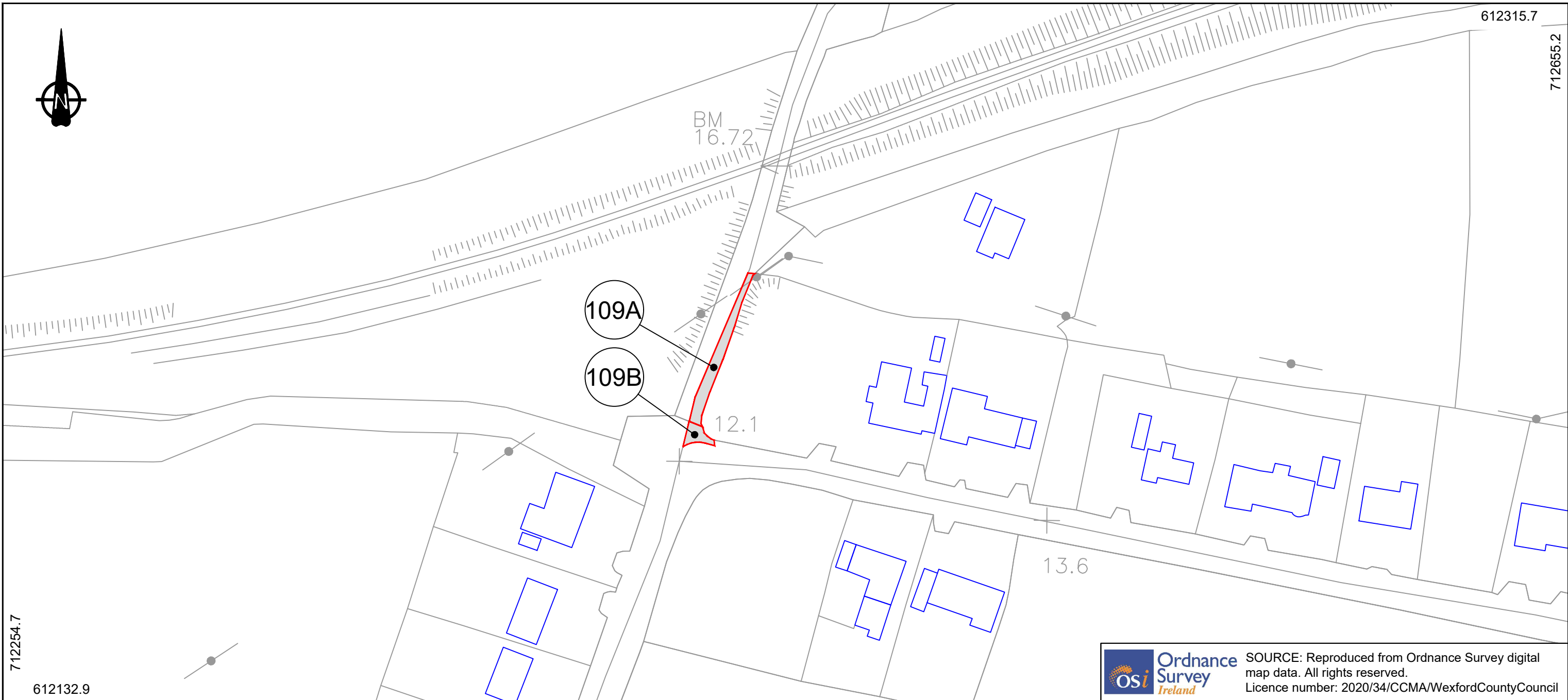

Plan Scale - 1:1,000

PLAN

O.S. Ref: 5715-A

SCHEDULE PART I : LAND OTHER THAN LAND CONSISTING OF A HOUSE OR HOUSES UNFIT FOR HUMAN HABITATION AND NOT CAPABLE OF BEING RENDERED FIT FOR HUMAN HABITATION AT REASONABLE EXPENSE.

No. on Map Deposited at the Offices of the Local Authority	Area (Ha)	Townland	Electoral District	Description	Owners or Reputed Owners	Lessees or Reputed Lessees	Occupiers
109A	0.0100	Ballygerry	St. Helen's	Private Road	David Michael Laheen	*	David Michael Laheen
109B	0.0027	Ballygerry	St. Helen's	Public Road	David Michael Laheen	*	David Michael Laheen

© Mott MacDonald

This Document is issued for the party which commissioned it and for specific purposes connected with the captioned project only. It should not be relied upon by any other party or used for any other purpose. We accept no responsibility for the consequences of this document being relied upon by any other party, or being used for any other purpose, or containing any error or omission which is due to an error or omission in data supplied to us by other parties.

NOTE:
 Denotes Lands covered by Compulsory Purchase Order



Notes
 1. DO NOT SCALE, use figured dimensions only. All dimensions to be checked on site.
 2. All levels are referred to Ordnance Survey Datum, Malin Head.
 3. Drawings co-ordinates are at Irish Grid
 4. This drawing to be read in conjunction with all relevant works requirements specifications and drawings.

Rev.	Date	Drawn	Description	Chk'd	Appr.
A	22/03/2022	ME	For Information	JOR	JS
B	12/05/2022	ME	For Information	JOR	JS

N25 Rosslare Europort Access Road	
Title:	Lands to be Compulsorily Acquired David Michael Laheen C.P.O. Plot No's 109A & 109B
Designed:	M.Ebert
Drawn:	M.Ebert
Checked:	J. O'Riordan
Approved:	J. Shinkwin
Status:	CPO
Drawing No.:	229100548-MMD-0000-RE-DR-C-0031
Scale at A3:	1:1000
Rev:	B

Schedule – Part I

Land Proposed to be Compulsorily Acquired

Land other than land consisting of houses unfit for human habitation and not capable of being rendered fit for human habitation at reasonable expense

No. on Map Deposited at the Offices of the Local Authority	Area (Ha)	Townland	Electoral District	Description	Owners or Reputed Owners	Lessees or Reputed Lessees	Occupiers
100A	0.0078	Ballygillane Little	St. Helen's	Public Road	Wexford County Council	*	Wexford County Council
100B	0.1417	Ballygillane Little	St. Helen's	Public Road	Wexford County Council	*	Wexford County Council
101A	0.0135	Ballygillane Little	St. Helen's	Public Road	Wexford County Council	*	Wexford County Council
102A	0.0417	Ballygerry	St. Helen's	Agricultural Land	Breda Kelly	*	Breda Kelly
102B	0.0436	Ballygerry	St. Helen's	Agricultural Land	Breda Kelly	*	Breda Kelly
102C	0.9540	Ballygerry	St. Helen's	Public Road	Breda Kelly	*	Wexford County Council
102D	0.0008	Ballygerry	St. Helen's	Public Road	Breda Kelly	*	Wexford County Council
102E	0.0051	Ballygerry	St. Helen's	Private Road	Breda Kelly	*	Breda Kelly
102F	0.0191	Ballygerry	St. Helen's	Agricultural Land	Breda Kelly	*	Breda Kelly
102G	0.0102	Ballygerry	St. Helen's	Land from Commercial Property	Breda Kelly	*	Breda Kelly
103A	0.0021	Ballygerry	St. Helen's	Land from Commercial Property	Irish Water	*	Irish Water
103B	0.0073	Ballygerry	St. Helen's	Public Road	Irish Water	*	Wexford County Council
103C	0.0139	Ballygerry	St. Helen's	Private Road	Irish Water	*	Irish Water
103D	0.0595	Ballygerry	St. Helen's	Private Road	Irish Water	*	Irish Water
103E	0.0069	Ballygerry	St. Helen's	Private Road	Irish Water	*	Irish Water
104A	0.0282	Churchtown	St. Helen's	Agricultural Land	Breda & Pat Heffernan	*	Breda & Pat Heffernan
104B	0.0390	Churchtown	St. Helen's	Public Road	Breda & Pat Heffernan	*	Wexford County Council
105A	0.1219	Ballygerry/Churchtown	St. Helen's	Public Road	National Veh. Distribution LTD	*	Wexford County Council
105B	0.0209	Ballygerry	St. Helen's	Private Road	National Veh. Distribution LTD	*	National Veh. Distribution LTD
105C	0.1900	Churchtown	St. Helen's	Land from Commercial Property	National Veh. Distribution LTD	*	National Veh. Distribution LTD
105D	0.4510	Ballygerry	St. Helen's	Agricultural Land	National Veh. Distribution LTD	*	National Veh. Distribution LTD
106A	0.4337	Ballygerry	St. Helen's	Dwelling and Lands	Anne Gleeson	*	Anne Gleeson
106B	0.0171	Ballygerry	St. Helen's	Private Road	Anne Gleeson	*	Anne Gleeson
107A	0.0007	Ballygerry	St. Helen's	Private Road	John Paul Kelly	*	John Paul Kelly
107B	0.0002	Ballygerry	St. Helen's	Private Road	John Paul Kelly	*	John Paul Kelly
107C	1.9640	Ballygerry	St. Helen's	Agricultural Land	John Paul Kelly	*	John Paul Kelly
107D	0.9643	Ballygerry	St. Helen's	Agricultural Land	John Paul Kelly	*	John Paul Kelly
108A	0.5344	Ballygerry	St. Helen's	Railway Area	Coras Iompair Eireann (C.I.E)	*	Coras Iompair Eireann (C.I.E)
108B	0.1090	Ballygerry	St. Helen's	Private Road	Coras Iompair Eireann (C.I.E)	*	Coras Iompair Eireann (C.I.E)
108C	0.0252	Ballygerry	St. Helen's	Public Road	Coras Iompair Eireann (C.I.E)	*	Coras Iompair Eireann (C.I.E)
108D	0.0048	Ballygerry	St. Helen's	Railway Area	Coras Iompair Eireann (C.I.E)	*	Coras Iompair Eireann (C.I.E)
108E	0.0051	Ballygerry	St. Helen's	Railway Area	Coras Iompair Eireann (C.I.E)	*	Coras Iompair Eireann (C.I.E)
108F	0.0709	Ballygerry	St. Helen's	Private Road	Coras Iompair Eireann (C.I.E)	*	Coras Iompair Eireann (C.I.E)
108G	0.0005	Ballygerry	St. Helen's	Private Road	Coras Iompair Eireann (C.I.E)	*	Coras Iompair Eireann (C.I.E)
108H	0.6051	Ballygerry	St. Helen's	Private Lands	Coras Iompair Eireann (C.I.E)	*	Coras Iompair Eireann (C.I.E)
108I	0.1653	Ballygerry	St. Helen's	Private Road	Coras Iompair Eireann (C.I.E)	*	Coras Iompair Eireann (C.I.E)
108J	0.4287	Ballygerry	St. Helen's	Private Lands	Coras Iompair Eireann (C.I.E)	*	Coras Iompair Eireann (C.I.E)
108K	0.0091	Ballygerry	St. Helen's	Private Lands	Coras Iompair Eireann (C.I.E)	*	Coras Iompair Eireann (C.I.E)
108L	0.0038	Ballygerry	St. Helen's	Private Road	Coras Iompair Eireann (C.I.E)	*	Coras Iompair Eireann (C.I.E)
108M	0.0384	Ballygerry	St. Helen's	Private Lands	Coras Iompair Eireann (C.I.E)	*	Coras Iompair Eireann (C.I.E)
108N	0.3704	Ballygerry	St. Helen's	Railway Area	Coras Iompair Eireann (C.I.E)	*	Coras Iompair Eireann (C.I.E)

No. on Map Deposited at the Offices of the Local Authority	Area (Ha)	Townland	Electoral District	Description	Owners or Reputed Owners	Lessees or Reputed Lessees	Occupiers
108O	0.0347	Ballygerry	St. Helen's	Private Lands	Coras Iompair Eireann (C.I.E)	*	Coras Iompair Eireann (C.I.E)
108P	0.0058	Ballygerry	St. Helen's	Private Road	Coras Iompair Eireann (C.I.E)	*	Coras Iompair Eireann (C.I.E)
108Q	0.0887	Ballygerry	St. Helen's	Private Lands	Coras Iompair Eireann (C.I.E)	*	Coras Iompair Eireann (C.I.E)
109A	0.0100	Ballygerry	St. Helen's	Private Road	David Michael Laheen	*	David Michael Laheen
109B	0.0027	Ballygerry	St. Helen's	Public Road	David Michael Laheen	*	David Michael Laheen

Schedule – Part II

Description of Public Right of Way Proposed to be Extinguished

Non - National Routes

- 1) The section of Local Road No. L3068 in the Townland of Ballygillane Little and Ballygerry between the lines 1-1 & 1A-1A for a distance of 460m
- 2) The section of Local Road No. L7021 in the Townland of Ballygerry between the lines 2-2 & 2A-2A for a distance of 255m

Official Seal

N25 Rosslare Europort Access Road Wexford County Council Compulsory Purchase Order No. 9 of 2022

The Official Seal of the Local Authority was affixed hereto this _____ day of _____ 2022 in the presence of

Cathaoirleach

Chief Executive

County Secretary