

Notes

1. Original Drawing size is A1. DO NOT SCALE, use figured dimensions only, if in doubt ask.
2. All dimensions are in metres.
3. All coordinates are to Irish Transverse Mercator.
4. This Scheme is at Preliminary Status and may change at Detail Design Stage as the design progresses.
5. Mainline Design Speed 60km/h.

Key to symbols

- Site Boundary
- Proposed Horizontal Alignment
- Proposed Vertical Alignment
- - - Existing Ground

Scale bars:
 1:200: 0, 10m, 20m
 1:1000: 0, 50m, 100m

Reference drawings

229100548-MMD-0100-RE-DR-C-0100 - Key Plan for Mainline Horizontal & Vertical Alignment Drawings
 229100548-MMD-0100-RE-DR-C-0101 - Mainline Horizontal & Vertical Alignment - Sheet 1 of 3
 229100548-MMD-0100-RE-DR-C-0102 - Mainline Horizontal & Vertical Alignment - Sheet 2 of 3

Rev	Date	Drawn	Description	Ch'k'd	App'd
P05	19/04/2022	ME	For Information	JOR	JS
P04	07/04/2022	ME	For Information	JOR	JS
P03	10/03/2022	ME	For Information	JOR	JS
P02	07/10/2021	ME	For Information	JOR	JS
P01	05/10/2021	ME	For Information	JOR	JS

Status Stamp

Preliminary Design

MOTT MACDONALD

5 Eastgate Avenue
 Eastgate
 Little Island
 Cork
 Ireland
 T +353 (0) 21 4809800
 F +353 (0) 21 4809801
 W www.mottmac.com

Client

Wexford County Council
 Carricklawn
 Wexford
 Y35 WY93

Comhairle Contae Loch Garman
Wexford County Council

Title

N25 Rosslare Europort Access Road Phase 3 Mainline Horizontal & Vertical Alignment

Sheet 03 of 03

Designed	M.EBERT	ME	Eng check	J. O'RIORDAN	JOR
Drawn	M.EBERT	ME	Coordination		---
Dwg check	J. O'RIORDAN	JOR	Approved	J.SHINKWIN	JS
MMD Project Number	229100548	Scale at A1	1:1000	Security	STD
Drawing Description					
Mainline Horizontal & Vertical Alignment (Sheet 3 of 3)					
Drawing Number	229100548-MMD-0100-RE-DR-C-0103	Revision	P05		

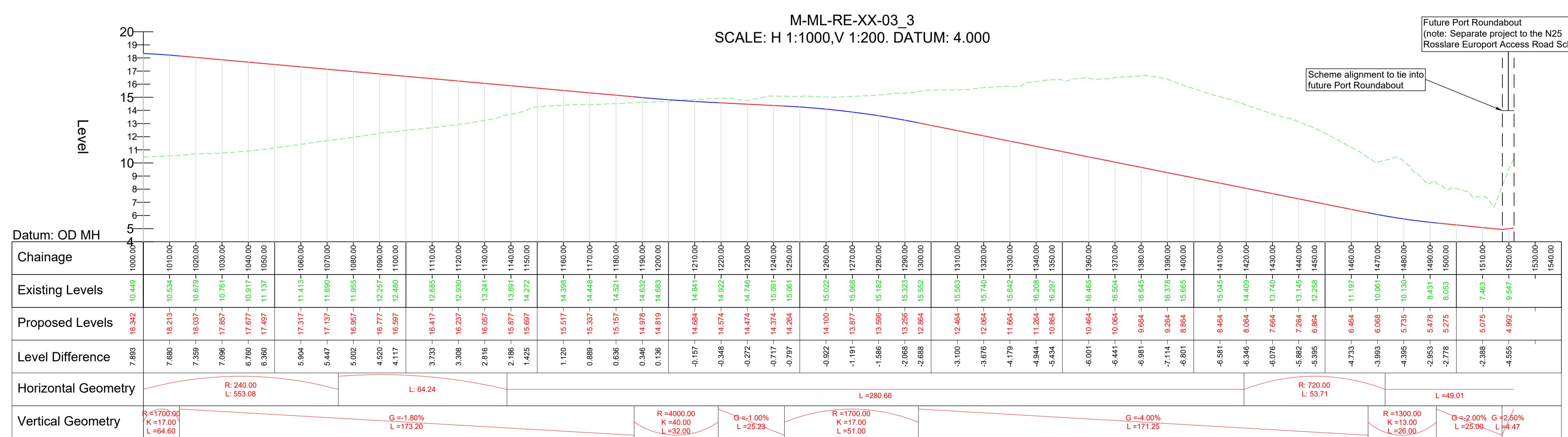

© Mott MacDonald Ireland
 This document is issued for the party which commissioned it and for specific purposes connected with the captioned project only. It should not be relied upon by any other party or used for any other purpose.
 We accept no responsibility for the consequences of this document being relied upon by any other party, or being used for any other purpose, or containing any error or omission which is due to an error or omission in data supplied to us by other parties.